

# DOBOT Nova Series Product Specifications

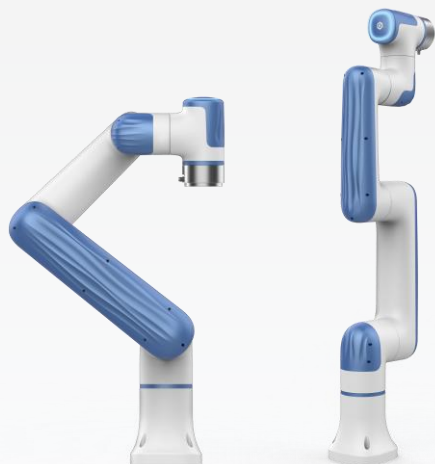

Product		Nova 2	Nova 5
Body weight		11 kg (24.3 lbs)	14 kg (30.9 lbs)
Rated load		2 kg (4.4 lbs)	5 kg (11 lbs)
Working radius		625 mm (24.6 in)	850 mm (33.5 in)
Maximum working speed		1.6 m/s (63 in/s)	2 m/s (78.7 in/s)
Range of motion	J1	±360°	±360°
	J2	±180°	±180°
	J3	±156°	±160°
	J4	±360°	±360°
	J5	±360°	±360°
	J6	±360°	±360°
Maximum joint speed	J1	135°/s	100°/s
	J2	135°/s	100°/s
	J3	135°/s	100°/s
	J4	135°/s	100°/s
	J5	135°/s	100°/s
	J6	135°/s	100°/s
End IO	DI	2 inputs	2 inputs
	DO	2 outputs	2 outputs
	RS485	Support	Support
Repeated Positioning accuracy		±0.05 mm	±0.05 mm
IP rating		IP54	IP54
Noise		65 dB(A)	70 dB(A)
Temperature range		0~50°C	0~50°C
Power consumption	Typical value	100 W	230 W
	Maximum value	250 W	770 W
Installation mode		Any angle	
Cable length from robot body to electric cabinet		3 m (118.1 in)	
Material		Aluminum alloy, acrylonitrile butadiene Styrene plastic	



Product		Controller
Size		200*120*55 mm (7.9*4.7*2.2 in)
Weight		1.3 kg (2.9 lbs)
Input power		30~60V DC
IO power		24V, Max 2A, Max 0.5A for each channel
IO interface	DI	8 inputs (NPN or PNP)
	DO	8 outputs (NPN or PNP)
	AI	2 inputs, voltage mode, 0~10V
	AO	2 outputs, voltage mode, 0~10V
Communication interface	Network interface	2, for TCP/IP and Modbus TCP communication
	USB	2, for connecting USB wireless module
	485 interface	1, for RS485 and Modbus RTU communication
Environment	Temperature	0~50°C
	Humidity	≤95%, non-condensation
Remote power on/off		Support
IP rating		IP20
Cooling mode		Passive heat loss
Teaching mode		PC, APP (Android, iOS)

# Nova 2

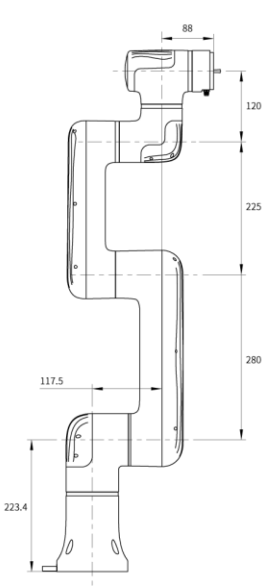

▲ Overall dimension diagram

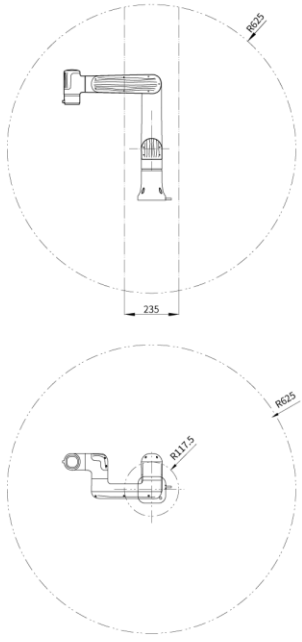

▲ Motion range diagram

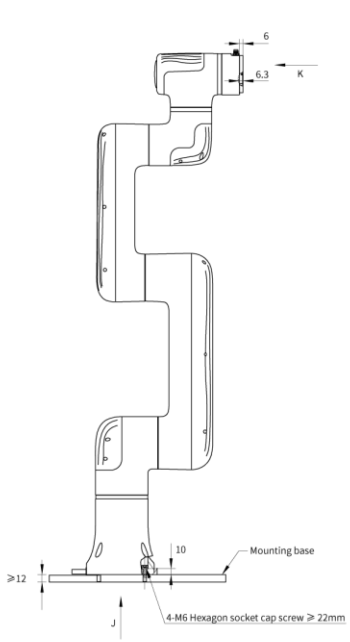

▲ Mounting hole diagram

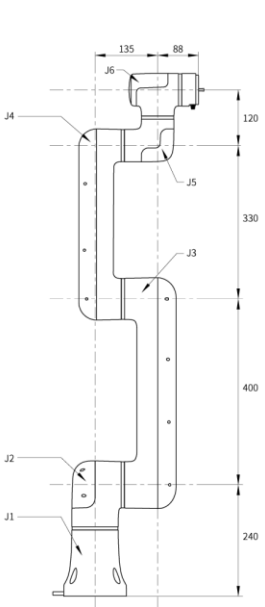
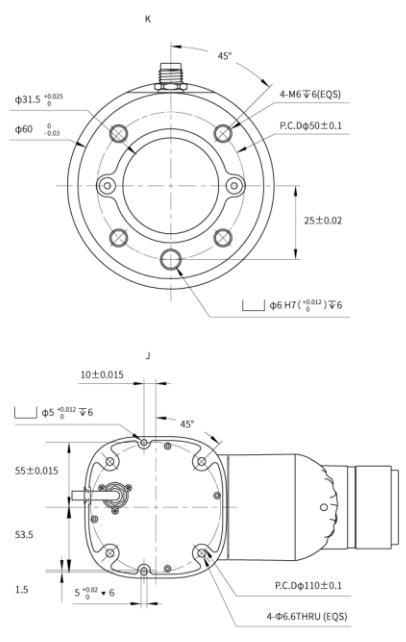

▲ Overall dimension diagram

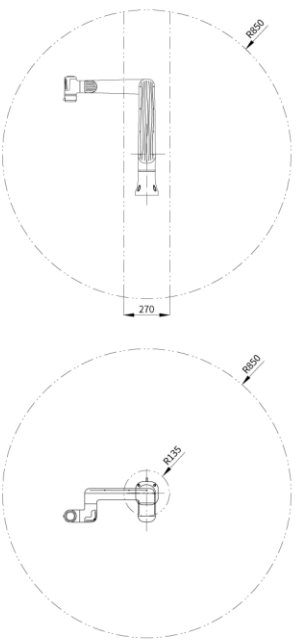

▲ Motion range diagram

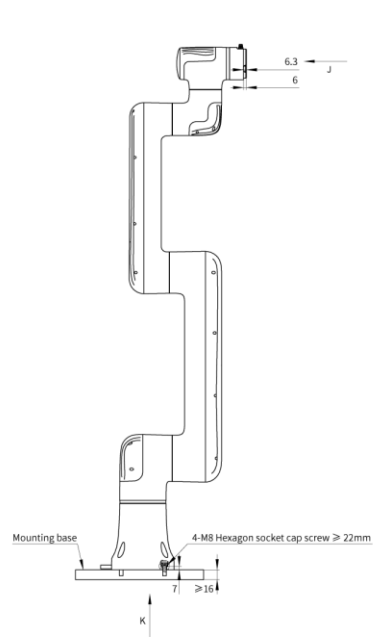

▲ Mounting hole diagram

